

仙游石苍35kV输变电工程勘测定界图  
2834.0-40373.8

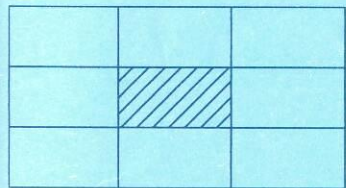

8 403

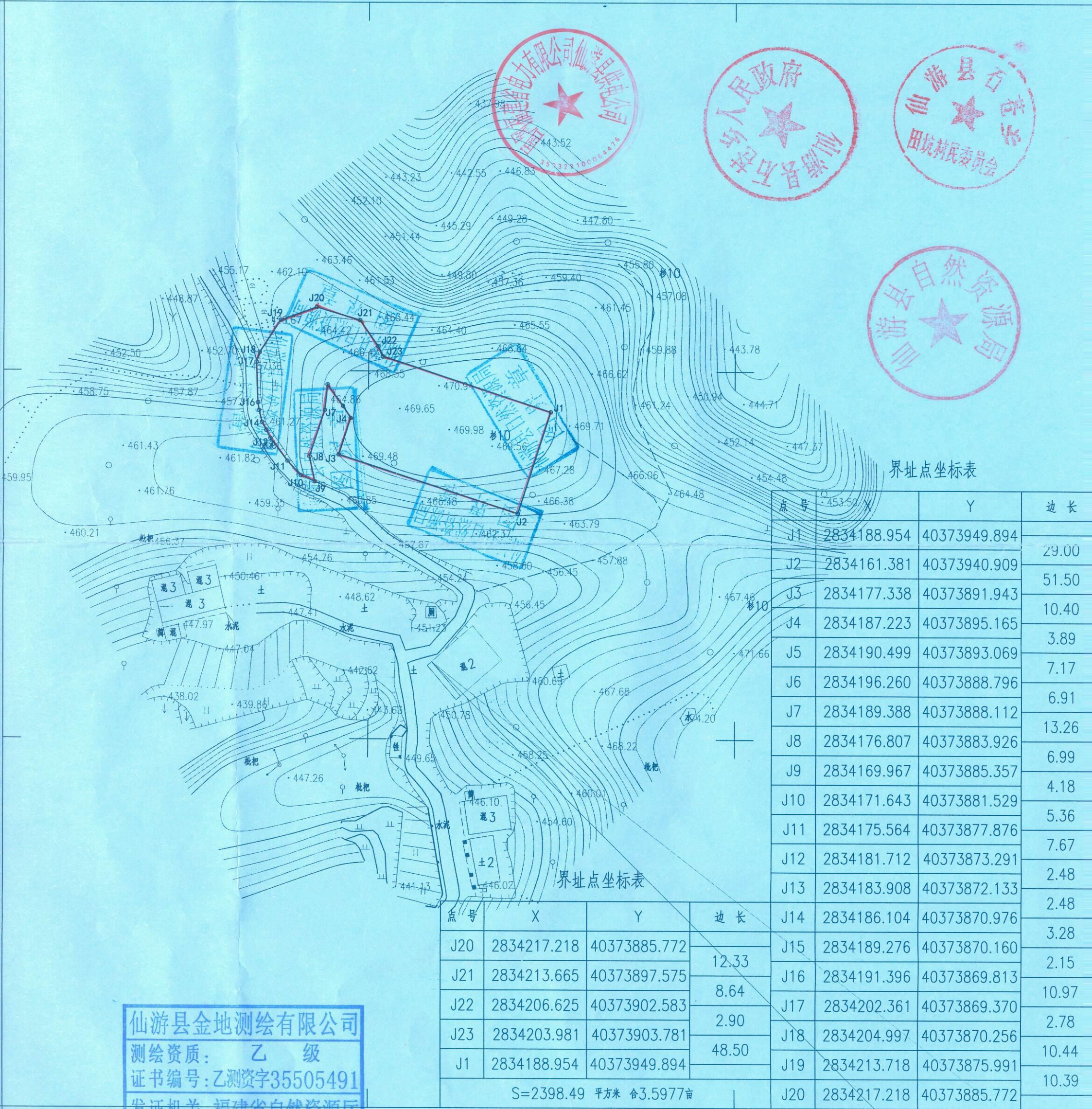

仙游县金地测绘有限公司  
测绘资质：乙级  
证书编号：乙测资字35505491  
发证机关：福建省自然资源厅

点号	X	Y	边长
J1	2834188.954	40373949.894	29.00
J2	2834161.381	40373940.909	51.50
J3	2834177.338	40373891.943	10.40
J4	2834187.223	40373895.165	3.89
J5	2834190.499	40373893.069	7.17
J6	2834196.260	40373888.796	6.91
J7	2834189.388	40373888.112	13.26
J8	2834176.807	40373883.926	6.99
J9	2834169.967	40373885.357	4.18
J10	2834171.643	40373881.529	5.36
J11	2834175.564	40373877.876	7.67
J12	2834181.712	40373873.291	2.48
J13	2834183.908	40373872.133	2.48
J14	2834186.104	40373870.976	3.28
J15	2834189.276	40373870.160	2.15
J16	2834191.396	40373869.813	10.97
J17	2834202.361	40373869.370	2.78
J18	2834204.997	40373870.256	10.44
J19	2834213.718	40373875.991	10.39
J20	2834217.218	40373885.772	
J21	2834213.665	40373897.575	12.33
J22	2834206.625	40373902.583	8.64
J23	2834203.981	40373903.781	2.90
J1	2834188.954	40373949.894	48.50
S=2398.49 平方米 合3.5977亩			